

# NANLITE

wand LED Full-color Wand Light

## USER MANUAL

Version: V1.0  
2025-05-26

## Revision History

Version	Date (Y-M-D)	Note
V1.0	2025-5-26	File First Publish

# Contents

1. Introduction .....	1
2. Product Overview .....	2
2.1. Product Layout .....	2
2.2. Specifications .....	3
2.3. Includes .....	4
3. Safety Instructions .....	5
4. Installing Instructions .....	7
4.1. Connecting the Fixture with the Power Source .....	7
4.2. Installing via 1/4"-20 Mount .....	7
4.3. Installing and Detaching the Barndoor .....	8
4.4. Installing the Diffuser .....	8
5. Operating Instructions .....	9
5.1. Turning On/Off .....	9
5.2. On-board Control .....	10
5.3. NANLINK APP Control-via Bluetooth .....	12
5.4. Menu .....	13
5.5. Firmware Update .....	14
6. Troubleshooting for Common Issues .....	14

# 1. Introduction

Thank you for purchasing the Nanlite product – wand!

The wand is a full-color LED wand light designed for versatile lighting applications. It features a dual power system, supporting both USB-C and NP-F batteries, allowing users to switch power sources based on shooting requirements. The fixture offers adjustable color temperature from 2700K to 7500K, with high color accuracy for reliable performance. It includes 36,000 color options and 14 built-in lighting effects, suitable for still life photography, creative lighting setups, and personal portrait shooting. It can be controlled via the NANLINK APP, enabling wireless control and synchronized lighting effects for more flexible and efficient workflows.

Before using wand, please read this manual carefully to ensure you can fully utilize all the features. Hope it can work with you to create more brilliant results together.

## 2. Product Overview

### 2.1. Product Layout

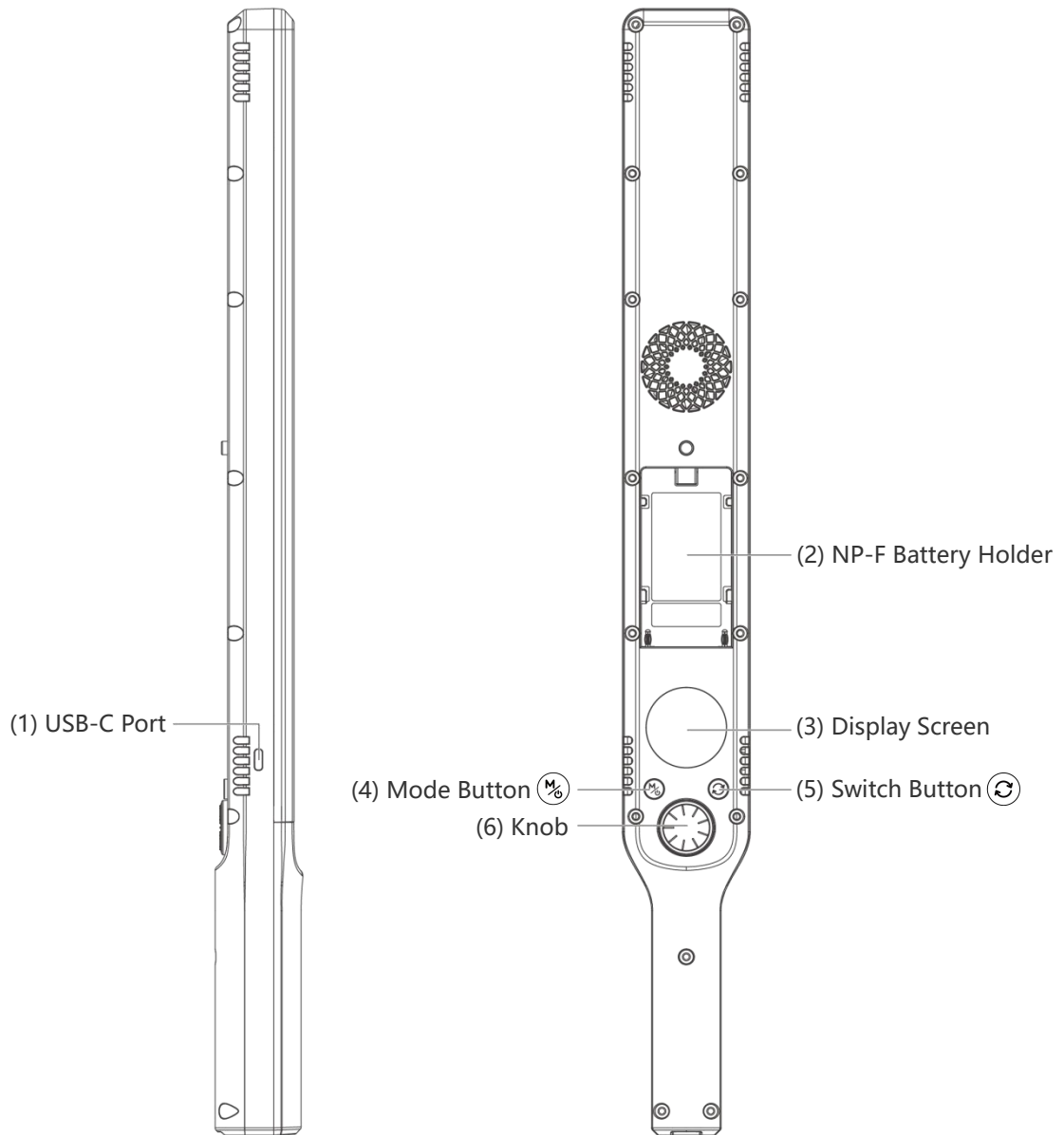

(1) USB-C Port: For connecting the power source.

(2) NP-F Battery Holder: For installing an NP-F battery to power the fixture.

(3) Display Screen: For displaying the lighting status and settings.

(4) Mode Button (M%): For switching between CCT, HSI, effect modes, and the menu, also turning the fixture on or off.





(5) Switch Button (↺): For switching parameters or options.

(6) Knob: For adjusting parameters or options.

## 2.2. Specifications

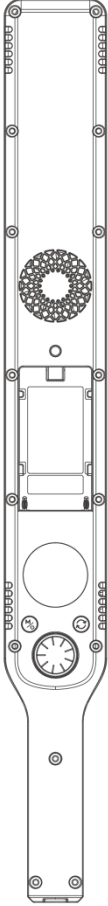
Model Name	wand
Rated Power	30W
Input Voltage/Current	7.4V NP-F battery PD3.0 adapter PD3.0 (9-20V) 20W Min
LED Light Engine	Nebula C4 Light Engine: RGBW
CCT	2700K→7500K (GM±150)
CRI	Average 95
TLCI	Average 93
TM-30 Rf	Average 92
TM-30 Rg	Average 99
Dimming	0%→100%, by 1% increment
Control	On-board, NANLINK APP
Special Effects	Hue Loop, CCT Flash, Hue Flash, CCT Pulse, Hue Pulse, Storm, Police Car, TV, Paparazzi, Candle/Fire, Disco, Bad Bulb, Firework and Explosion

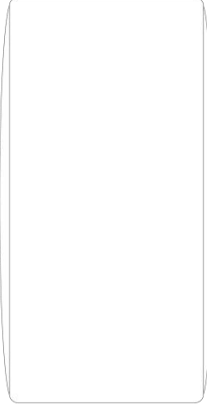
## 2.3. Includes

wand × 1	Barndoor × 1	Diffuser × 1
		
	Carrying Bag × 1	User Manual × 1
		

## 3. Safety Instructions

Please read and understand all safety instructions before installing or operating the fixture. Always follow the instructions to avoid personal injury and fixture damage. Retain all safety and operating instructions for future reference.

### Electrical:



#### **Danger**

Please keep the fixture away from liquids or damp environments to prevent short circuits and other accidents.



#### **Caution**

Please ensure that the fixture is turned off before storing or transporting.



#### **Caution**

Please use proper and undamaged USB-C cable to connect the fixture correctly, avoiding the risk of electric shock or fixture damage.

### Installation:



#### **Caution**

Please pay special attention to the impact of wind and take appropriate reinforcement measures when installing outdoors.

### Operation:



#### **Danger**

Please stop using the fixture immediately if the fixture housings show visible damage.



#### **Danger**

Please do not use the fixture near flammable or explosive materials.



#### **Danger**

Please be cautious, as the flashing effect may trigger seizures.



## Caution

Please ensure the fixture is used in an environment between -20°C and 45°C; operating outside this temperature range may damage the fixture.



## Caution

Please do not look directly at the light source without wearing protective glasses, as this may cause irreversible eye injury.



## Caution

Please do not allow children to use this fixture to prevent accidents.

### Maintenance:



## Caution

Please ensure the fixture is completely dry before operating or storing it after exposure to moisture.



## Notice

Please do not disassemble or repair any part of the fixture on your own, as this will void the warranty. Maintenance and repair work should be carried out by an authorized service center and professional personnel.



## Notice

Please ensure the fixture is stored away from the following environments or items: extreme temperatures, direct sunlight, high humidity, strong vibrations, pressure damage, dust, strong magnetic fields, and flammable or explosive substances.

## 4. Installing Instructions

### 4.1. Connecting the Fixture with the Power Source

The fixture can be powered by a charger or power bank, and also supports NP-F battery power.

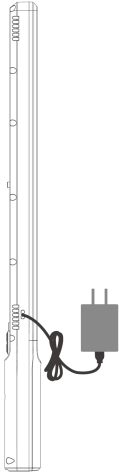

powered by charger

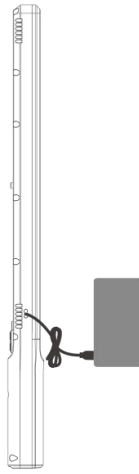

powered by power bank



powered by NP-F battery

▲Note: ①The charger, power bank, USB-C cable and NP-F battery are not included.

②The charger or power bank must comply with the PD 3.0 standard (9–20V, 20W or above), and the USB-C cable must support the PD 3.0 protocol.

③After installing the NP-F battery, if the charger or power bank is also connected, the fixture will prioritize battery power. To use the charger or power bank for power supply, please remove the battery.

### 4.2. Installing via 1/4"-20 Mount

The fixture is designed with a 1/4"-20 mount, enabling it to be installed on a tripod, light stand, or ball head, for various mounting options. (These accessories are sold separately.)

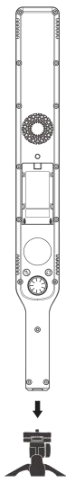

Tripod



Light Stand



Ball Head

### 4.3. Installing and Detaching the Barndoor

**Installation:**

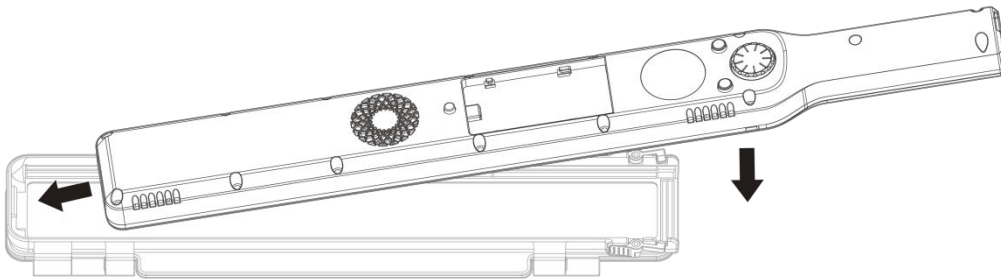

To install the barndoor, align it with the mounting slot on the top of the fixture and insert it. Press down firmly to secure it in place.

**Detachment:**

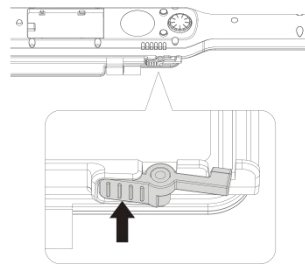

Press the quick release catch on both sides of the barndoor to remove it from the fixture.

### 4.4. Installing the Diffuser

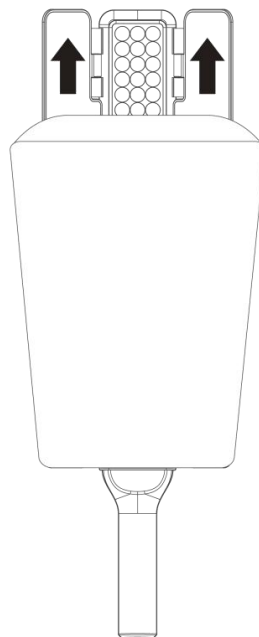

To install the diffuser, wrap it on the barndoor directly.

## 5. Operating Instructions

### 5.1. Turning On/Off

①The fixture can be powered by a charger or power bank. When "Auto On" is set to on, the fixture will power on automatically once connected to a power source. If "Auto On" is set to off, press the **Mode button** (M%) for 2s to turn on the fixture.

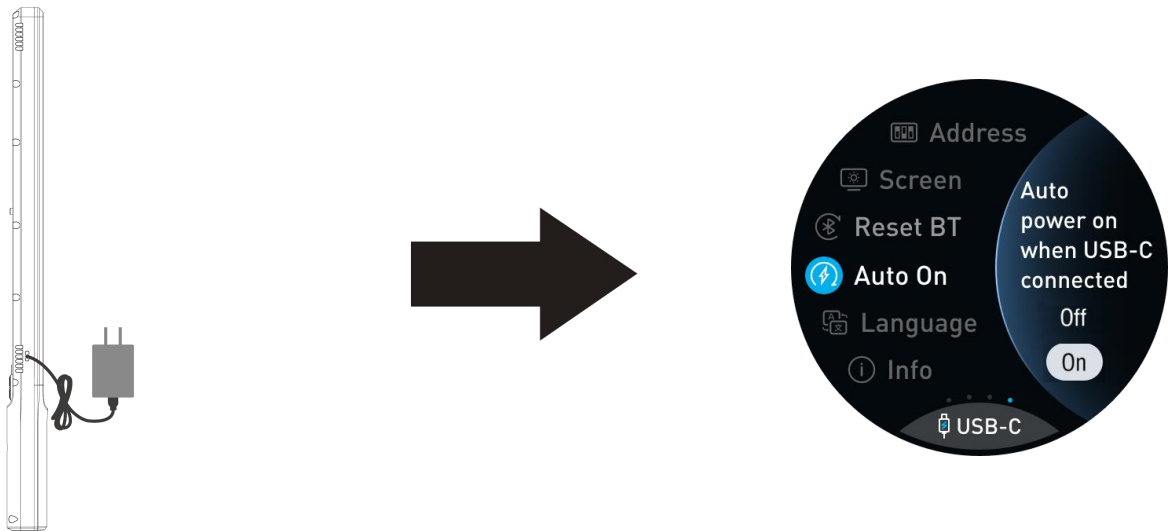

②When powered by an NP-F battery, press the **Mode button** (M%) for 2s to turn on the fixture. To turn off the fixture, press the **Mode button** (M%) for 2s.

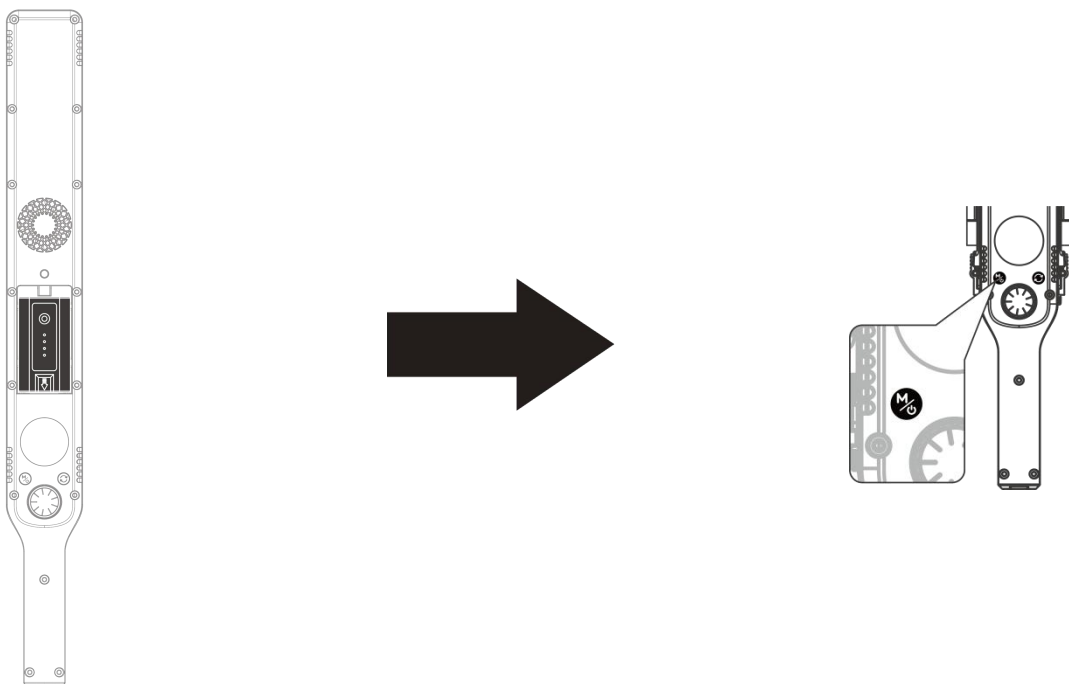

## 5.2. On-board Control

### (1) Interface Switching

Press the **Mode button** (M) to switch to the next mode interface. The total mode interfaces include CCT mode, HSI mode, Effect mode, and the Menu.

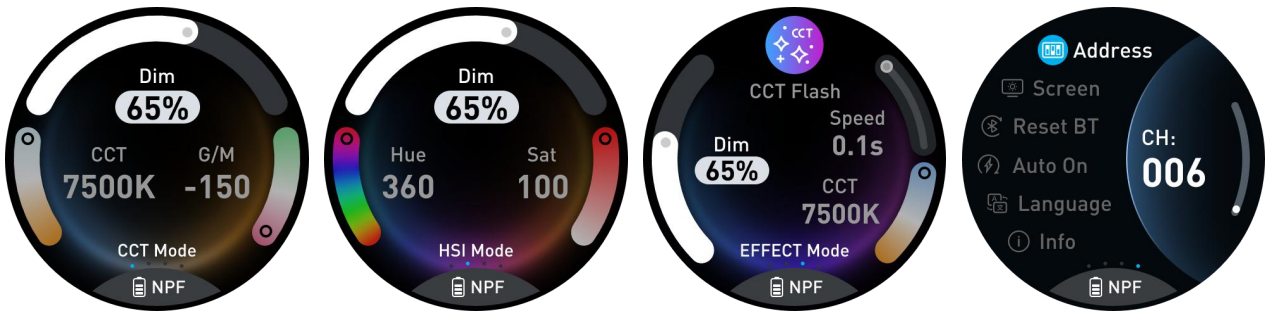

### (2) Mode Operation

#### ① CCT Mode

Press the **Switch button** (S) to toggle between brightness, color temperature, and green/magenta adjustment. Rotate the **Knob** to adjust the corresponding value.

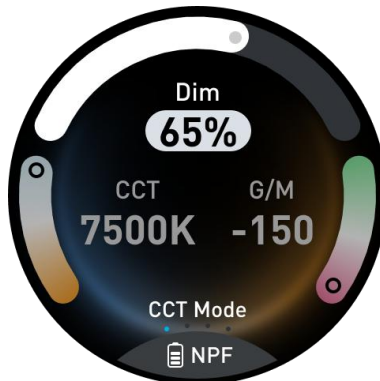

#### ② HSI Mode

Press the **Switch button** (S) to toggle between brightness, hue, and saturation. Rotate the **Knob** to adjust the corresponding value.

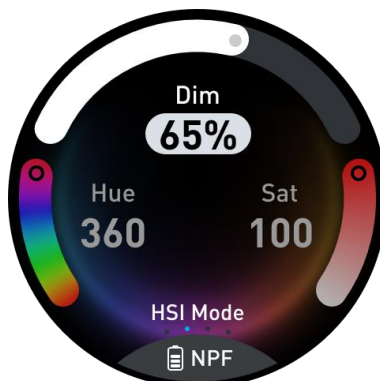

### ③ Effect Mode

Press the **Switch button** (🔄) to select parameters (including the effects). Rotate the **Knob** to adjust the corresponding value (or switch the effects).

The wand has 14 built-in effects, including Hue Loop, CCT Flash, Hue Flash, CCT Pulse, Hue Pulse, Storm, Police Car, TV, Paparazzi, Candle/Fire, Disco, Bad Bulb, Firework and Explosion.



## (3) Power Display Instructions

### ① Powered by charger or power bank

When the fixture is powered via a USB-C cable connected to a charger or power bank, a plug icon will appear in the status bar at the bottom of the screen.



### ② Powered by NP-F battery

When the fixture is powered by an NP-F battery, a battery icon will appear in the status bar at the bottom of the screen.



The battery icons and the corresponding battery levels:

Icon					
Battery Level	0%→5%	6%→25%	26%→50%	51%→75%	76%→100%

### 5.3. NANLINK APP Control-via Bluetooth

Turn on the Bluetooth of the phone, enter the NANLINK app, in the scene interface and open the right sidebar to add a fixture: Scene → Menu button at the top right → New Fixture → Via Bluetooth.

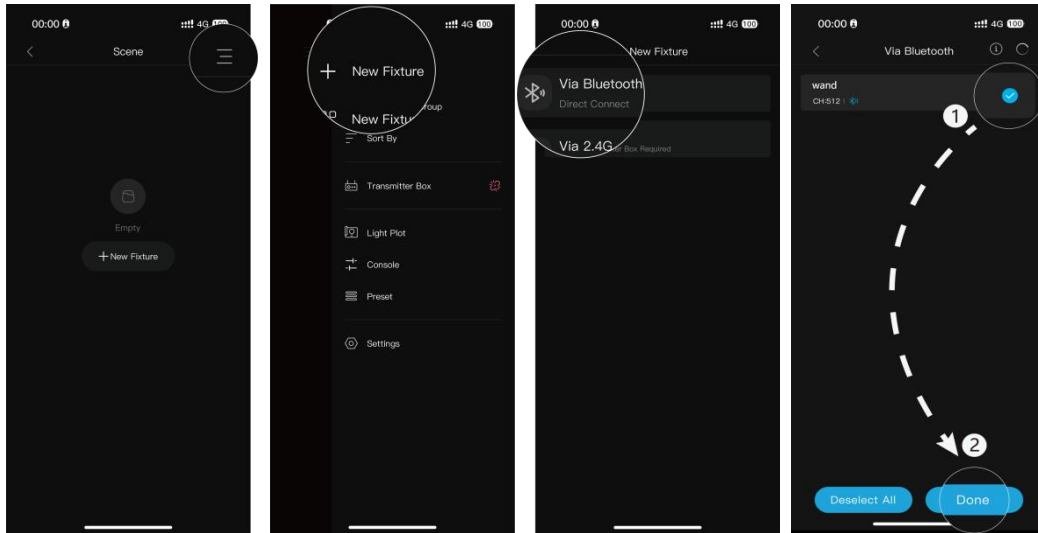

If the fixture can't be searched on the app, please reset the Bluetooth on the fixture and try again.

**Reset Bluetooth:** In the menu, select the Reset Bluetooth, then long press the **Switch button** (⌚) to reset the Bluetooth.



After connecting via Bluetooth, tap the fixture just added in the fixture list on the app to enter the control interface. Then, tap the mode in the top left corner to switch modes.

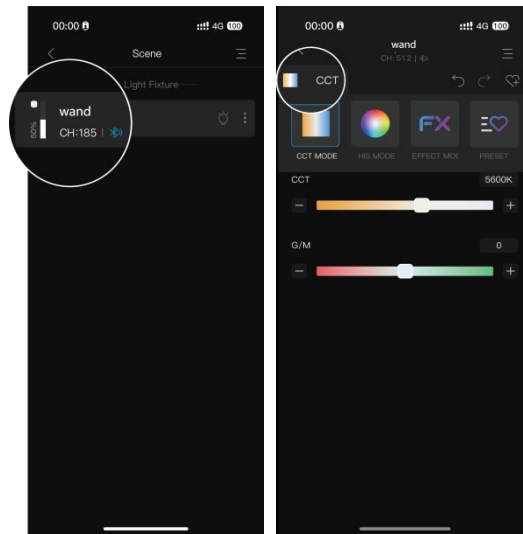

## 5.4. Menu

In the menu, there are options including Address, Screen Brightness, Reset Bluetooth, Auto On, Language, and Info. In the menu, press the **Switch button** (⌂) to select the menu, then rotate the **Knob** to adjust the parameters or options on the right side. After the operation is complete, the parameters or options will be automatically saved in real-time (except Reset Bluetooth and Info).



**Reset Bluetooth:** Press the **Switch button** (⌂) to select the Reset Bluetooth, then long press the **Switch button** (⌂) to reset Bluetooth.

**Info:** Displays the version information of fixture, with no options to operate.

## 5.5. Firmware Update

Connect the fixture to the phone, download and update the fixture's firmware through the App. The specific steps are as follows:

In the scene list where the fixture is located, tap the menu button on the right side of the navigation bar. In the settings, find Firmware Update and select the fixture that needs to be updated. Once the update is successful, the fixture will automatically restart to complete the firmware update.

- ▲ Note:
- ① If the instruction "Updated. Restart soon" is displayed, please do not operate, wait for 2s, and the fixture will automatically restart to complete the update.
  - ② If the instruction "Failed. Please retry on the APP" is displayed, please perform the firmware update again on the app.
  - ③ If the instruction "Failed. Please retry on the APP" is displayed, and the firmware update did not succeed again on the app, please gently insert the reset hole on the fixture using a pin, and update again.
  - ④ If the firmware update still fails after performing the above steps, please contact after-sales technical support.

## 6. Troubleshooting for Common Issues

Issues	Troubleshooting Guide
The fixture can't power up or be operated.	<ol style="list-style-type: none"> <li>1. Please check whether the power source is functioning properly. If the NP-F battery is out of power, please replace it or connect a charger/power bank to power the fixture.</li> <li>2. Please check whether the NP-F battery is 7.4V, or if the PD 3.0 power source supplies 9–20V at 20W or above.</li> <li>3. Please check whether the temperature is too high. Keep the fixture away from heat sources or provide proper ventilation for cooling.</li> </ol>
The fixture does not power on automatically when connected to a power source.	<ol style="list-style-type: none"> <li>1. Please make sure the power source is a charger or power bank, instead of a battery.</li> <li>2. Please make sure the "Auto On" function is turned on.</li> </ol>
Bluetooth cannot be connected during firmware update.	Please check whether a new device is connected. Long press the <b>Switch button</b>  for 2s to reset Bluetooth, then try again.
The screen brightness is too low.	<ol style="list-style-type: none"> <li>1. Please check the screen brightness settings in the menu and adjust to an appropriate level.</li> <li>2. Please check whether the screen is in sleep mode. Press any button or turn the <b>knob</b> to activate the screen.</li> </ol>

**Please scan the QR code for more details.**



【Nanlite Website】



【Nanlink App】

WWW.NANLITE.COM

**NANLITE**

✉ [info@nanlite.com](mailto:info@nanlite.com)

☎ +86-754-85751187

☎ +86-754-85300887

📍 Dongli Section, Highway 324, Chenghai, Shantou City, Guangdong Province, China